

1. A - Enter in working trot and proceed down the centre line
C - Track left

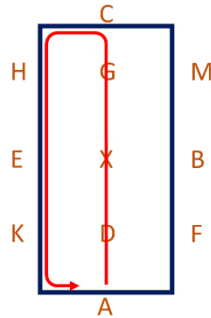

2. A - Circle left 20m diameter in working trot
F - Medium walk

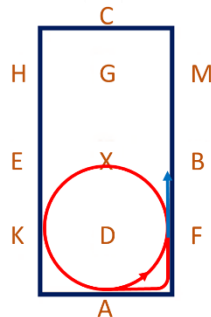

3. B - Turn left
E - Turn right

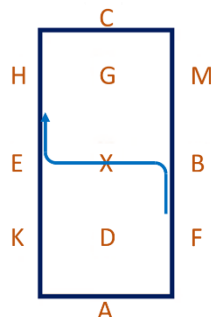

4. H - Working trot
C - Circle right 20m diameter in working trot

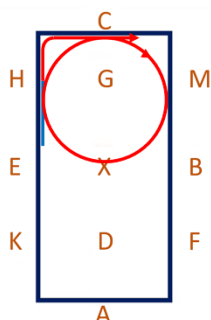

5. CMB - Working trot
B - Circle right 20m diameter and when crossing the centre line for the 2nd time transition to working canter right

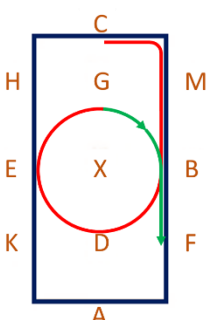

6. FAK - Working canter
K-M - Change the rein and just after X transition to working trot

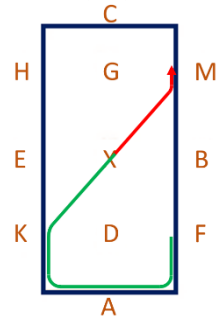

7. MCH - Working trot
E - Circle left 20m diameter and when crossing the centre line for the 2nd time transition to working canter left

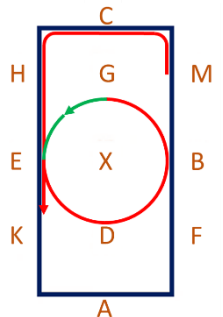

8. KAF - Working canter
F-H - Change the rein and just after X transition to working trot

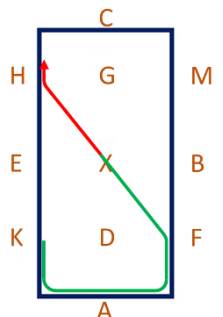

9. C - Medium walk
M-K - Change the rein in free walk on a long rein
K - Medium walk

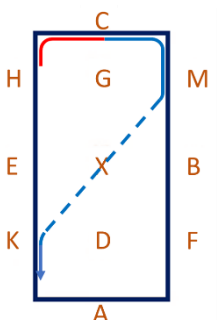

10. A - Working trot
B - Half circle left 20m diameter to E - give and retake the reins whilst crossing the centre line

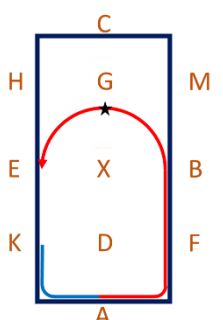

11. EKA – Working trot

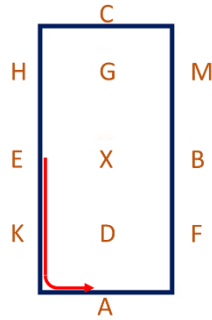

12. A – Turn down the centre line
G – Halt, Immobility, Salute

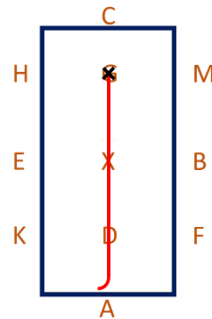

- Medium Walk
- - Walk on a Free Rein
- Working Trot
- Working Canter
- ★ Give and take reins
- ✕ Halt